

PHOTOSHOP TUTORIAL: SELECTIVE SEPIA

Learn how to use Photoshop to selectively add a dramatic sepia effect a photo.
Take as many photos as you like for **10 minutes**. Then choose **3 photos** to use this effect on.

Original Image (Before)



Selective Sepia Photoshop Tutorial (After)



Step 1: Open an image into Photoshop

Open the File menu and select Open. Browse for the photo you would like to add a selective sepia effect to and click OK.



Step 2: Create a Hue/Saturation adjustment layer

In the Layers pallet, click on the *New Adjustment Layer* icon and select *Hue/Saturation*.

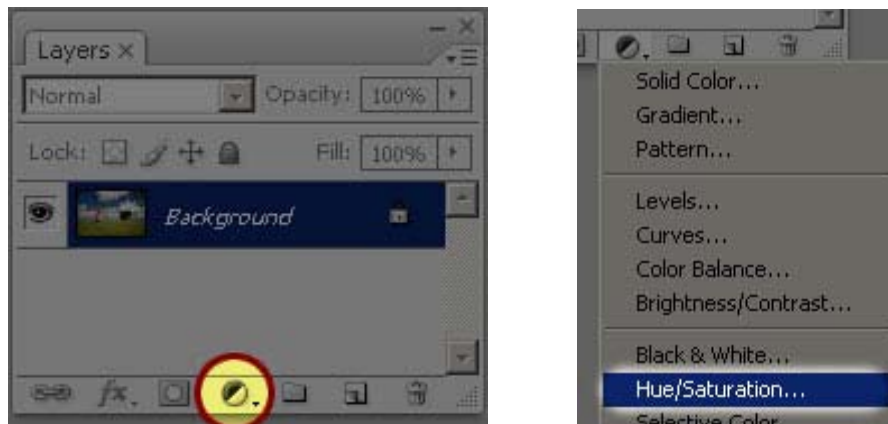

A *Hue/Saturation* window should appear. With this tool, we'll specify where the sepia effect will appear.

Set the master saturation to -100 and click OK. Your image should now appear grayscale.

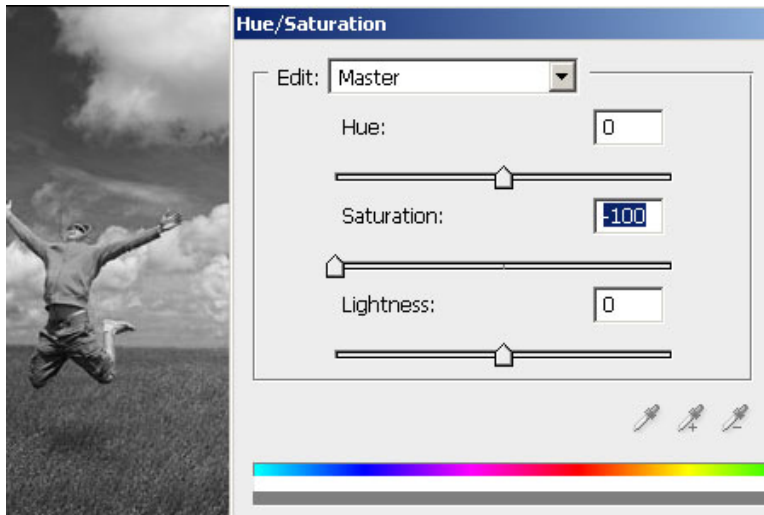

Activate the layer mask by clicking on the layer mask thumbnail in the *Layers* pallet. Select the Paint Brush tool and the color Black. Use it to color the areas where you don't want the sepia tone to be applied to.

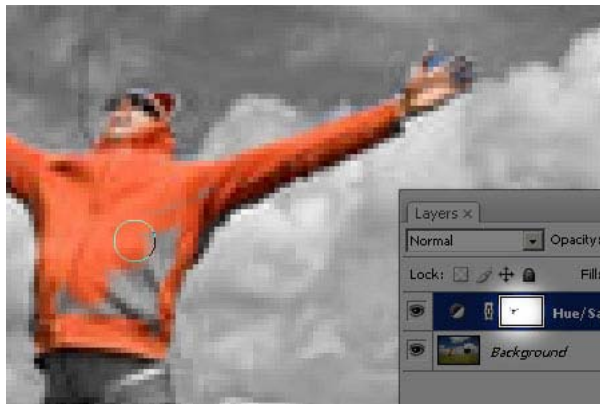

Step 3: Add another adjustment layer

In the Layers pallet, click on the *New Adjustment Layer* icon again and select *Hue/Saturation*.

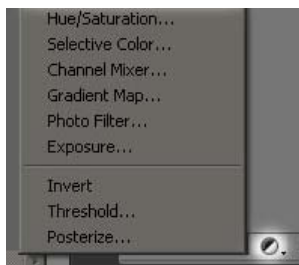

A Hue/Saturation adjustment layer should appear. Simply click OK without editing the settings. Then, change the blend mode of the top adjustment layer from **Normal** to **Overlay**. Double click back on the icon of the layer to bring back the tool.

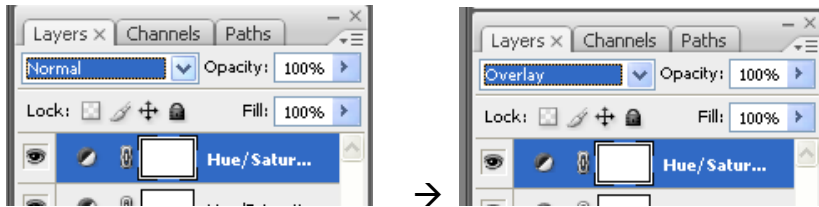

You will be using the Hue/Saturation tool to add a sepia tone. Checkmark "**Colorize**" and apply the settings below:

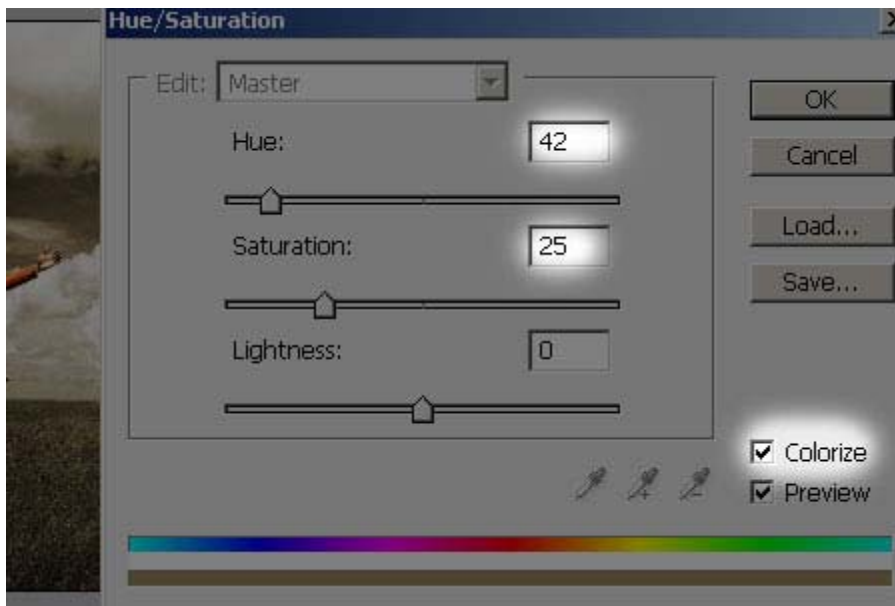

Final Results

Original Image (below)



After Selective Sepia Photoshop Tutorial



Red



Blue and Cyan



Yellow and Green



Red, Yellow, and Green

*Try this technique with as many pictures as you like. You **can choose up to 3** to turn in. Save your finished pictures as “**Selective Sepia 1, 2 and 3**”. Remember to save a jpeg to your Shared and a backup copy to your S Drive.*